

Thursday 2<sup>nd</sup> September

Dear Families,

### **Welcome to the New School Year**

We are really looking forward to welcoming our students back to Isca next week and are now in a position to confirm our plans for the Autumn Term. Our plans are based on the latest government guidance, as well as the additional local guidance being provided currently for the Exeter area.

#### **Contents**

[Staggered Start to the Year and LFT Testing](#)

[Arrival at, and departure from, school](#)

[Timings of the school day](#)

[Pastoral Check-In](#)

[‘Equipped to Learn’ packs](#)

[Lunch and Social Time](#)

[Expectations](#)

[iLife](#)

[Attendance](#)

#### **Staggered Start to the Year and LFT Testing**

- Current Government guidelines require us to ensure that students have 2 tests taken on site upon their return to school in September. This process remains voluntary and parental consent is needed before we can proceed. Where we already hold consent, this will continue to be valid. If you have not given consent in the past or if your child is joining us in Year 7, please complete the consent form here if you would like your child to take part in the testing [Student Testing Consent Form](#)
- Only students in Years 7 and 11 will be attending school on the first day of term - 8th September 2021, being joined by students in Years 8, 9 and 10 on the second day of term - 9th September 2021.
- Students with additional needs will be contacted by our SENDCo the day before the start of their year group so that any questions or concerns can be addressed. The SENDCo will assess the level and nature of support required for each student and where required an opportunity to come in to school will be offered.

#### **Lateral Flow Covid Testing – Appointment Times**

- For Test 1 students should arrive at school at the time specified below. They do not need to wear school uniform and once the test is completed, they will be free to go home again.

<b>Test 1 Monday 6<sup>th</sup> September – Year 7 &amp; 11</b>	
<b>13.00 to 14.00</b>	Year 11
<b>14.00 to 14.25</b>	Year 7 - Surnames A-G
<b>14.25 to 14.50</b>	Year 7 - Surnames H - P
<b>14.50 to 15.15</b>	Year 7 - Surnames Q - Z

Test 1 Tuesday 7 <sup>th</sup> September – Year 8, 9 and 10	
12.00 to 13.00	Year 8
13.00 to 14.00	Year 9
14.00 to 15.00	Year 10
2 <sup>nd</sup> Test – Completed during the school day	
Year 7 and 11	Thursday 9 <sup>th</sup> September
Year 8, 9 and 10	Friday 10 <sup>th</sup> September

### Arrival at, and departure from school in September

- Students should arrive at school no earlier than 8.30am, unless they plan to attend the quiet club. A pass is required for quiet club, which can be obtained from the school SENDCo by email request: [senco@iscaexeter.co.uk](mailto:senco@iscaexeter.co.uk)
- All students in Years 7, 8 and 9 will enter the building by the small atrium and all students in Years 10 and 11 will enter by the main entrance as shown on the plan below. Other entrances must not be used.
- Students, staff and all visitors to the school will be required to clean their hands using the sanitiser provided when entering and leaving the school building.
- Students, staff and all visitors to the school **will be required to wear a face covering when in communal areas** and when moving around the classrooms. This is an additional safety measure which will be regularly reviewed based on the current rates of Covid in the area. If your child is exempt from wearing a face covering and you would like an exemption badge for them to wear, please email [adminoffice@iscaexeter.co.uk](mailto:adminoffice@iscaexeter.co.uk)
- On arrival students will go to their designated Pastoral Check-in room, the details of these will be displayed at the relevant entrances on the first day.
- There will be no vehicle movement on site between 3.10pm and 3.25pm to allow the safe exit of our students.

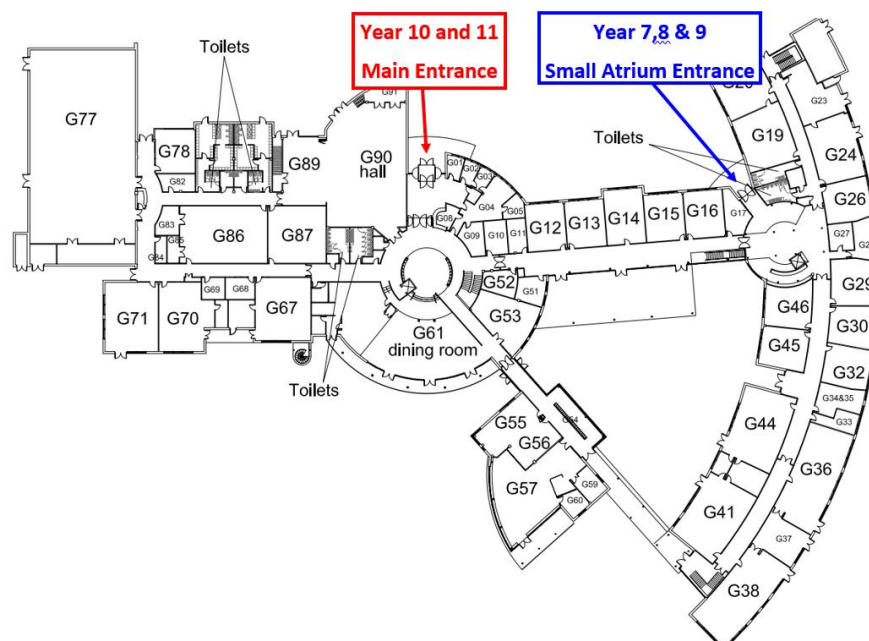

## Timings of the school day

Time	Lesson / Activity	
8.30am to 8.45am	Students arrive at school and enter the building via their nominated entrance	
8.45am to 8.55am	Pastoral check-in	
8.55am to 9.55am	Period 1	
9.55 to 10.55am	Period 2	
10.55 to 11.20am	Year 7/8 Break 1	Year 9/10/11 Tutor
11.20am to 11.45am	Year 7/8 Tutor	Year 9/10/11 Break 1
11.45am to 12.45pm	Period 3	
12.45pm to 1.45pm	Period 4	
1.45pm to 2.15pm	Break 2	
2.15pm to 3.15pm	Period 5	
3.15pm to 4.15pm	Period 6 – See below for details	

<b>Monday Period 6</b>	Year 11	Year 10	Year 9
<b>Tuesday Period 6</b>	Year 11	Year 10	Year 7
<b>Wednesday Period 6</b>	Year 11	Year 8	

All period 6 lessons will be included in your child's usual school timetable and attendance is expected, as it is with any other lesson.

### Pastoral Check-In

- From September, we have added an additional pastoral check in first thing in the morning (8:45 – 8:55)
- This is one of the most important parts of the day, as tutors will 'set students up' for a great day at Isca Academy. This session will ensure students are supported and have a warm welcome each morning before starting period 1.
- The tutor will meet students at the door and welcome them. Their 'Equipped to Learn' packs and homework will be checked and students will be given any daily updates. Students who arrive after 8.45 will go to the late room for their pastoral check in.

### 'Equipped to Learn' packs

From September, all students will be given an 'Equipped to Learn' pack which should be brought to school each day. They will be given the pack on their first day at school during an extended tutor time session. The pack contains the following:

Mesh Wallet A3 Knowledge Organiser Homework Book 'Track the Text' book mark	Mini White Board Mini Board Wiper Board Pen Bullet Tip Purple Pen	Black Pen HB Pencil Large Eraser 15 cm ruler Yellow Highlighter
--	--	---

## Lunch and Social Time

- Students will have full use of the canteen and their accounts should be topped up using SCOPay as cash will not be accepted. Students will be able to order their food directly in the canteen and meals will be provided in boxes so they can be taken to the designated year group area to be eaten. Year 7 only will be able to use the seating area in the canteen.
- Students will need to wear their face covering at all times when queuing or moving around the canteen. When sitting and eating, of course their face covering can be removed.
- Break and lunch times will be closely supervised and taken in the designated social spaces for each year group. Students will not be able to go to other areas of the school (apart from the canteen) or mix with peers in other year groups.
- The toilets off of the main atrium will be available for all students at break times.
- Students must bring their own water bottles for use in the school day. Water fountains can be used for bottle filling only and should not be used to drink water directly.

## Expectations

- All students should attend school in their full school uniform every day, please note only black socks will be permitted as part of the school uniform. Jackets for students moving from Year 9 into Year 10 can be ordered from Price and Buckland website accessible here <https://www.pbuniform-online.co.uk/iscaacademy>, as per the specifications given on our website.
- Students in Year 7 to 10 will be expected to have a school PE weather proof jacket from September and these can be ordered from Price and Buckland via the link above. This will allow all PE lessons to take place outside no matter what the weather. Year 11 students can purchase these if they wish.
- There is a requirement (due to local Covid rates) for students, staff and visitors to wear a face covering when in communal areas or moving around the classrooms. When sitting down or when outside face coverings can be removed. We will have face coverings available, should students need them but if they have their own, this is preferable. We will review this regularly and update you if this requirement changes. If your child is exempt from wearing a face covering and you would like an exemption badge for them to wear, please email [adminoffice@iscaexeter.co.uk](mailto:adminoffice@iscaexeter.co.uk)
- Normal expectations apply regarding hair, jewellery, make-up and nails. Please ensure that you remind yourselves of school expectations, as specified on our website in preparation for the start of term.
- The school remains a no mobile phone school and any phone seen on site during the school day will be taken by staff and returned at the end of the day, in line with our school policy, which can be found on the website.
- Our Ready to Learn (RTL) system will apply as normal.
- Students will be expected to sit in their seating plan in all classrooms.
- Students, like staff, will be expected to clean their hands and study equipment throughout the day using the sanitiser and disinfectant wipes provided.

## ILife

As you know, our exciting new ILife Programme starts this term. Students will make their choices when they return, and this will begin from Monday 13th September (the first full week of term). Each session will

develop a wide range of skills, and we are incredibly pleased to be able to provide such an array of different activities for our students.

<b>Year 7 will do a 6-week rotation of the following activities:</b>	<b>Year 8 will choose 3 of the following, and do a 12-week programme:</b>
Craft Capers	Netball Club
Learn a new instrument	Equality Champions
Green Car Challenge	Multi-sports
History in Motion	Anything Astronomical
Photography and Photoshop	Community Challenge
Wellbeing Walks	Outdoor Improvements
Philosophy for Kids	Design and Make
	Learn to Crochet
<b>Year 9's ILife experience will come from the Duke of Edinburgh's Award, plus 3 x 12-week activities, consisting of:</b>	<b>Year 10s will choose 3 of the following. Choices may be limited depending on students', timetables, which they will receive in September.</b>
Multi-sports	A Tour of Italy
Digital Skills Builder	iMedia/film making
School Newspaper	World of Dance
	DIY
	ICT
<b>Year 11</b>	School newspaper
	Multi-sports
	Cryptography
	Woolly craft
	World Issues
	Health Leaders
Year 11 will continue with their PSHE lessons, with a bespoke programme to include personal enrichment, Skills Builder, Careers Education and well-being.	

## Attendance

- Full attendance is expected by all of our students in September.
- If your child is not able to attend school for any reason, please contact the school in the normal way by emailing [attendance@iscaexeter.co.uk](mailto:attendance@iscaexeter.co.uk) or by calling the main school number (Tel: 01392 204082) before the start of the school day. If a child does not attend school and no contact has been received, we will contact home to clarify the reason for their absence in the usual way. It is really important that an accurate record of the reasons for absence is kept, so please provide as much detail as possible when contacting us.
- Students must remain at home if they have Covid-19 type symptoms. If this is the case please email [covid@iscaexeter.co.uk](mailto:covid@iscaexeter.co.uk) with the details.



**Year 7 Photo**

Our new year 7 students will have their school photos taken on Thursday 9<sup>th</sup> September.

If you have any questions or concerns regarding the plans above, please do not hesitate to contact us at: [adminoffice@iscaexeter.co.uk](mailto:adminoffice@iscaexeter.co.uk)

We are really excited for the year ahead and look forward to working closely with you in the coming months.

Yours sincerely,

Aimee Mitchell  
Headteacher